



**AMB PROPERTY CORPORATION**  
Local partner to global trade.™

# FOR LEASE



## 50,333 SF Available | 200 West Carob Street Compton, California

### 200 West Carob Street Compton, California 90220

Property Name	200 West Carob Street
City, State, Country	Compton, California, U.S.
Submarket	South Bay / Los Angeles
Property Type	Industrial Warehouse
Year Built/Renovated	1973
NRA	50,333 sf
Land	116,235 sf
Parking	55
Clear Height	20' Minimum
Loading	8 Truck High Positions
Loading	2 Ground Level Doors
Column Spacing	48' x 48' (Typical Bay)
Office Finish	5,582 sf (may be reduced)
Rail	Southern Pacific Rail Service
Zone Benefit	Foreign Trade Zone No. 202



Aerial Map



Location Map



**AMB PROPERTY CORPORATION**  
Local partner to global trade.™

# FOR LEASE

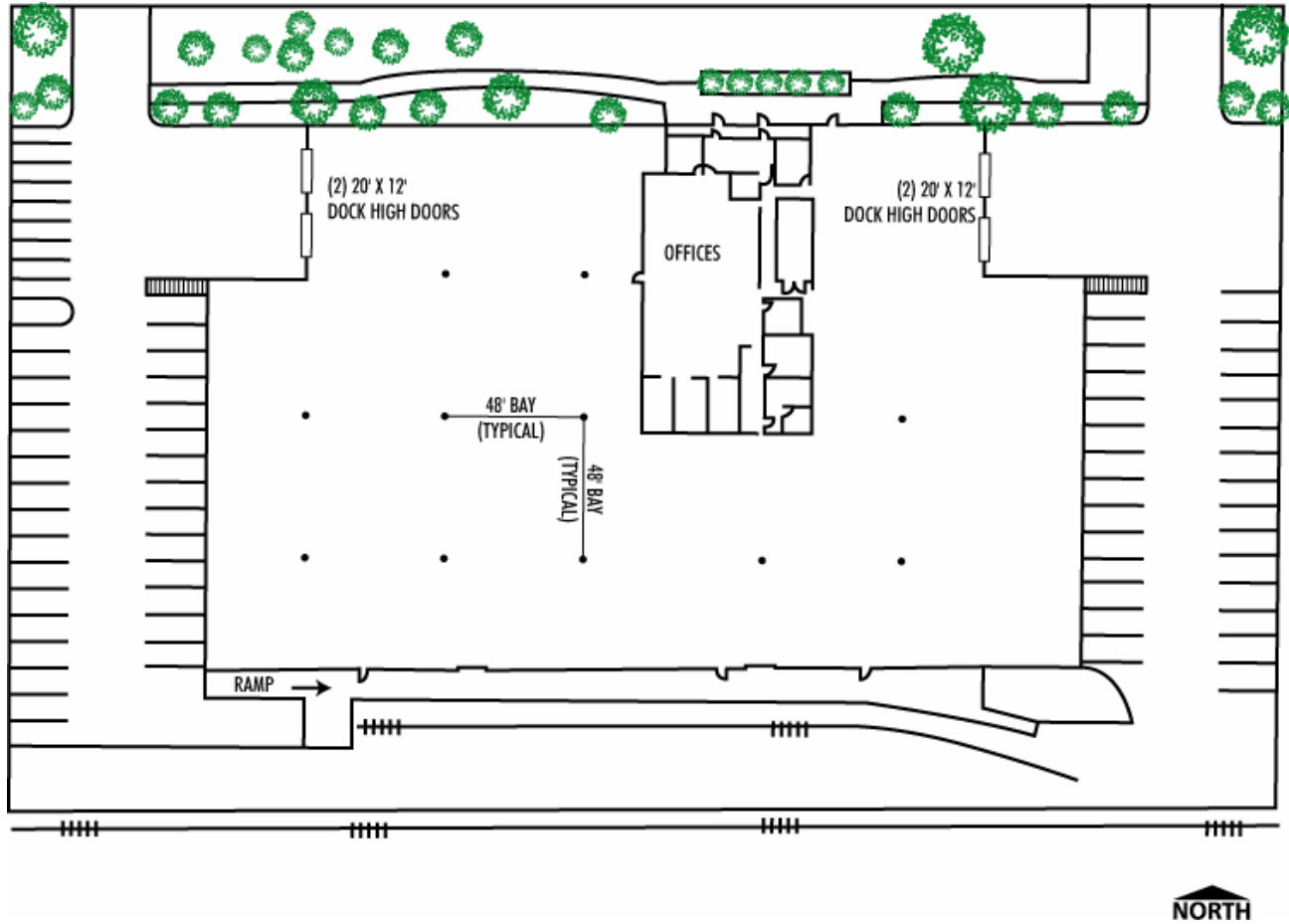

For additional information, please contact:

**John Schumacher**

Senior Vice President  
CB Richard Ellis, Inc.

Direct 310 516 2311

Fax 310 516 2313

Email [john.schumacher@cbre.com](mailto:john.schumacher@cbre.com)

**Jeffrey Morgan**

Senior Vice President  
CB Richard Ellis, Inc.

Direct 310-516-2337

Fax 310-516-2313

Email [jeff.s.morgan@cbre.com](mailto:jeff.s.morgan@cbre.com)



NO WARRANTIES OR REPRESENTATIONS, EXPRESSED OR IMPLIED, ARE MADE AS TO THE ACCURACY OR COMPLETENESS OF THE INFORMATION CONTAINED HEREIN AND SAME IS SUBMITTED SUBJECT TO ERRORS, OMISSIONS, RENTAL OR OTHER CONDITIONS, WITHDRAWAL WITHOUT NOTICE, AND TO ANY SPECIAL LISTING CONDITIONS IMPOSED BY OUR PRINCIPALS. ALL SIZES ARE APPROXIMATE. AMB MAKES NO COMMITMENT TO UPDATE THE INFORMATION CONTAINED HEREIN, AND MAY MAKE CHANGES TO THESE MATERIALS AT ANY TIME WITHOUT NOTICE. IN NO EVENT SHALL AMB OR ITS AFFILIATES BE LIABLE FOR ANY DAMAGES WHATSOEVER (INCLUDING, WITHOUT LIMITATION, DAMAGES FOR LOSS OF PROFITS, BUSINESS INTERRUPTION, OR LOSS OF OPPORTUNITY) ARISING OUT OF THE USE OF THE INFORMATION CONTAINED HEREIN.