

FOR LEASE

WILSONVILLE BUSINESS CENTER BUILDING 9

27501 SW 95TH AVENUE :: WILSONVILLE, OR 97070

Get out of the congestion of Beaverton and Hillsboro and discover the easily accessible and transit friendly flex/warehouse opportunities in Wilsonville, OR, at Wilsonville Business Center. Wilsonville Business Center offers immediate access to I-5 and the surrounding service areas of south Portland. It is convenient to a highly trained work force and an array of area amenities that provide essential services to the areas employment base.

LOCATION MAP



TRANSIT MAP



www.cbre.com/wbc

FEATURES:

- Corporate image and I-5 visibility
- Lightrail and front door transit service to the project
- Numerous space configurations (see floor plan on back)
- 16' clear height
- Up to 3/1,000 parking
- Grade level loading with common-dock access
- Easy access to I-5 and I-205
- Competitive lease rates (Call to request pricing sheet)

FOR MORE INFORMATION PLEASE CONTACT

Andy Kangas

503.221.4874

andy.kangas@cbre.com

www.cbre.com/andy.kangas

Preston C. Greene

503.221.4887

preston.greene@cbre.com

www.cbre.com/preston.greene

CBRE
CB RICHARD ELLIS

FOR LEASE

WILSONVILLE BUSINESS CENTER - BUILDING 9

27501 SW 95TH AVENUE :: WILSONVILLE, OR 97070

GENERAL SPECIFICATIONS:

BUILDING TOTAL
42,816 SF

SITE AREA:
168,650 SF

PARKING
120 SPACES - 2.9/1,000

CLEAR HEIGHT:
16' - 20'

VACANCY SPECIFICATIONS:

VACANT SUITE #980:
5,686 SF (SHELL)
1,344 SF (OFFICE)
1 DOCK DOOR
1 GRADE DOOR
COMMON DOCK

VACANT SUITE #945:
4,148 SF (SHELL)
3,386 SF (OFFICE)
1 GRADE DOOR AND
COMMON DOCK

VACANT SUITE #930:
3,935 (SHELL)
2,037 (OFFICE)
1 GRADE DOOR AND
COMMON DOCK

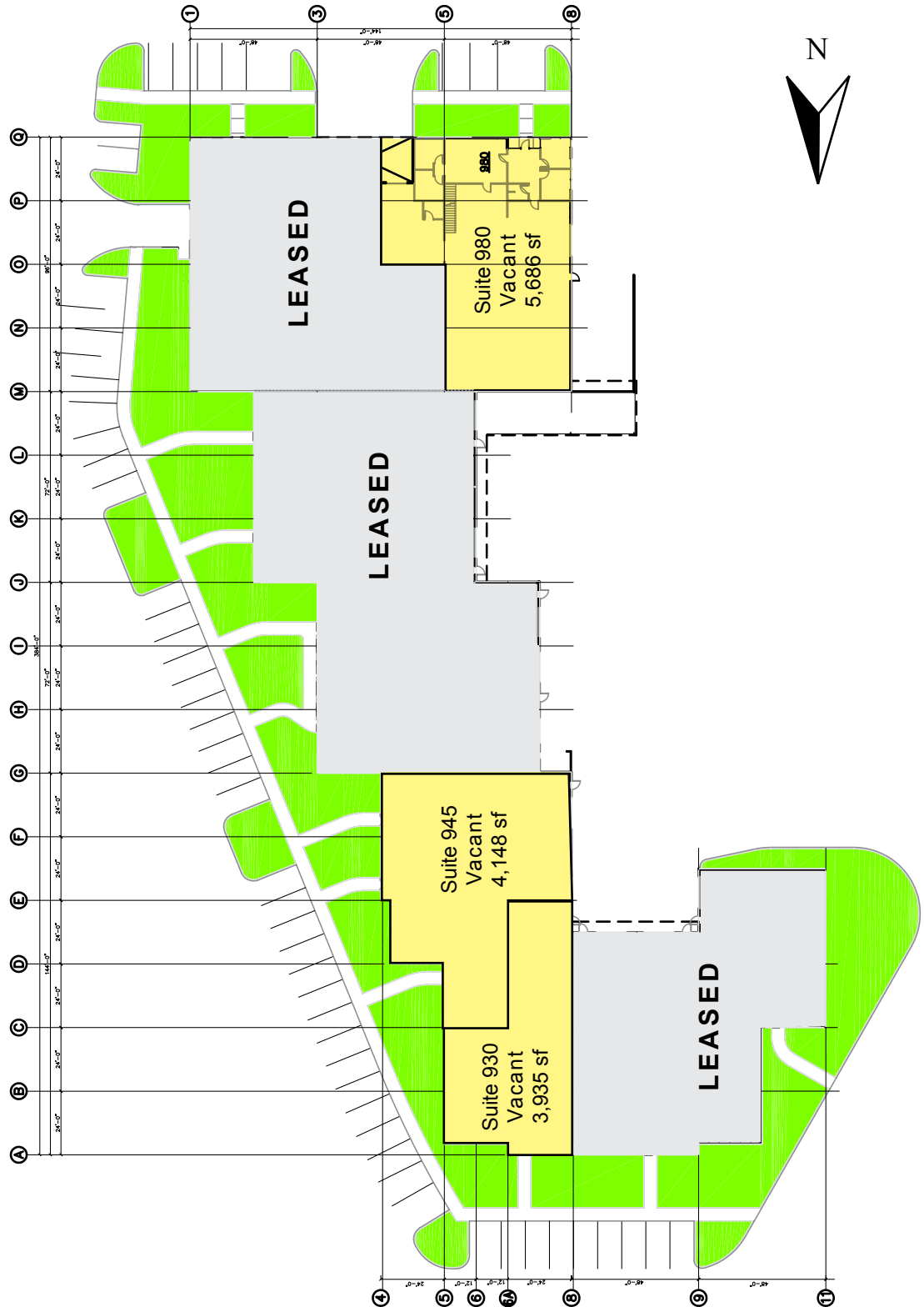

CB Richard Ellis | 1300 SW Fifth Ave. | Suite 3000 | Portland, OR 97201

© 2011 CB Richard Ellis, Inc. This information has been obtained from sources believed reliable. We have not verified it and make no guarantee, warranty or representation about it. Any projections, opinions, assumptions or estimates used are for example only and do not represent the current or future performance of the property. You and your advisors should conduct a careful, independent investigation of the property to determine to your satisfaction the suitability of the property for your needs.