

Office Suites for Lease

Property Overview

Offered for lease are multiple office suites totaling ±10,300 RSF within a larger ±20,256 SF building in the municipality of Colonie (Latham mailing address).

Tax ID	19.3-1-10.3
2024 Assessment	\$850,000
Equalization Rate	51%
2023 General Tax	\$10,590.70
2023/2024 School Tax	\$23,074.44
Combined Tax	\$33,665.14
Zoning	ABA:Airport Business Area
Utilities	Municipal water and Sewer

For Lease at: \$16.50/SF Gross plus base year increases

Contact Us

Brenda Garretson, CCIM

Licensed Associate Real Estate Broker
+1 518 452 2700 x 136
Brenda.Garretson@cbre-albany.com

Dan Simpson, CCIM

Licensed Associate Real Estate Broker
+1 518 452 2700 x 125
Dan.Simpson@cbre-albany.com

CBRE Upstate NY

210 Washington Avenue Ext.
Albany, NY 12203
+1 518 452 2700
www.cbre.com/Albany

[Click HERE to View Property](#)



4 Avis Drive

Latham | New York 12110

Office Space Property Details

- + Close to CDTA Bus Stops
- + ±90 parking spaces
- + Double doors for sales/service business (suite 105)
- + Less than 1 Mile from exit 6 of I-87 (the Adirondack Northway)
- + Proximate to many amenities along Route 7 (Troy Schenectady Road) and Route 9 (Loudon Road)
- + Owner/manager on site
- + Vending machines, outdoor picnic area

Directions

- + Located: [Exit 6 of I-87 to Route 7, to Wade Road to Avis Drive.](#)

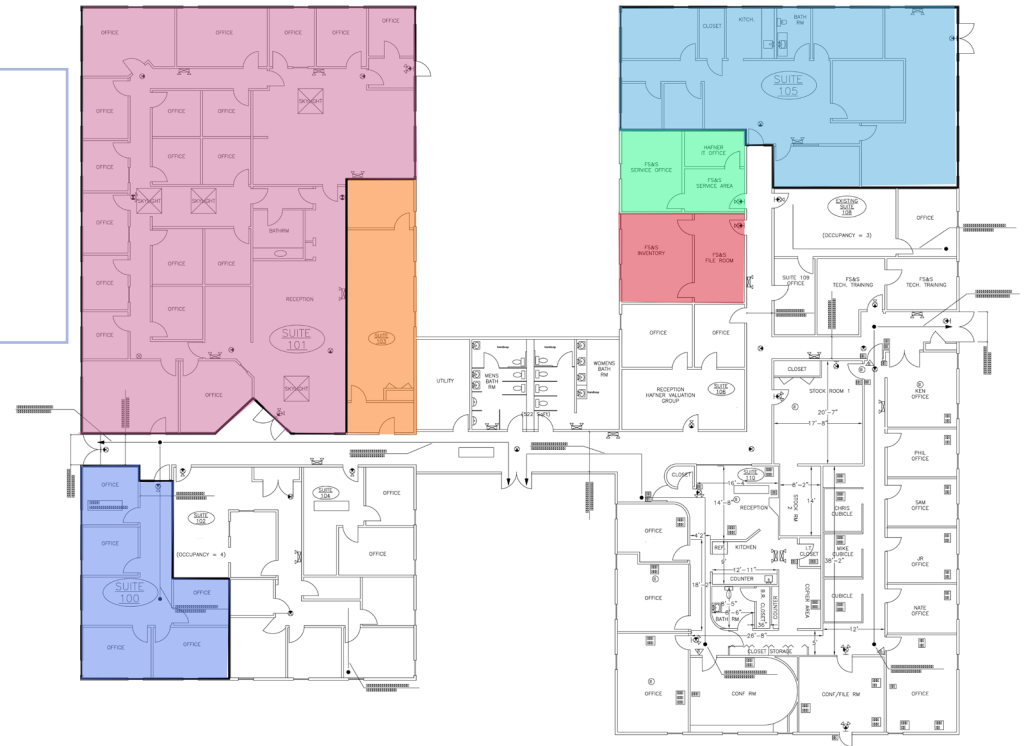

For Lease

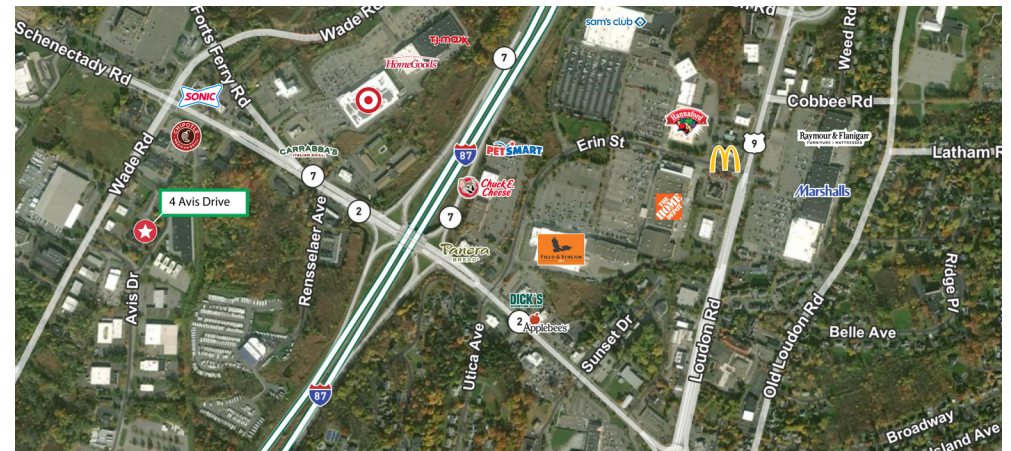

© 2023 CBRE Upstate NY, part of the CBRE Affiliate Network. All rights reserved. This information has been obtained from sources believed reliable, but has not been verified for accuracy or completeness. You should conduct a careful, independent investigation of the property and verify all information. Any reliance on this information is solely at your own risk. CBRE Upstate NY and the CBRE Upstate NY logo are service marks of CBRE Upstate NY. All other marks displayed on this document are the property of their respective owners, and the use of such logos does not imply any affiliation with or endorsement of CBRE Upstate NY. Photos herein are the property of their respective owners. Use of these images without the express written consent of the owner is prohibited.