

# FULL FLOOR AVAILABLE

OFFICE SPACE FOR LEASE

# 88 W. COLORADO

PASADENA, CA

## BUILDING HIGHLIGHTS



Asking Rate: \$3.00 MG



Creative office space located in the heart of OldTown Pasadena



North facing Colorado Boulevard & mountain views



Walk Score: 97 (Walker's Paradise)



Surrounded by an abundance of restaurants & shops



Easy 210, 110 & 134 freeway accessibility



Strong local ownership



Direct access via elevator & escalator

**CBRE**



▲ **CONVENIENTLY** located escalators providing direct access to the office

▲ **PLENTY** of windows for ample natural lighting throughout

▲ **MOCK-UP** of staged office for a modern industrial look

▼ **SPACIOUS** conference room area

▼ **FLOOR PLAN** - 8,488 RSF

**FOR MORE INFORMATION, PLEASE CONTACT:**

**KEVIN DUFFY**

Senior Vice President  
Lic. 01032613  
+1 818 502 6724  
kevin.duffy@cbre.com

**NATALIE BAZAREVITSCH**

Senior Vice President  
Lic. 01188604  
+1 818 502 6723  
natalie.bazarevitsch@cbre.com

**JACKIE BENAVIDEZ**

Vice President  
Lic. 01894070  
+1 818 502 6758  
jackie.benavidez@cbre.com

**SEAN O'MALLEY**

Sales Associate  
Lic. 02192775  
+1 818 907 4699  
sean.omalley@cbre.com

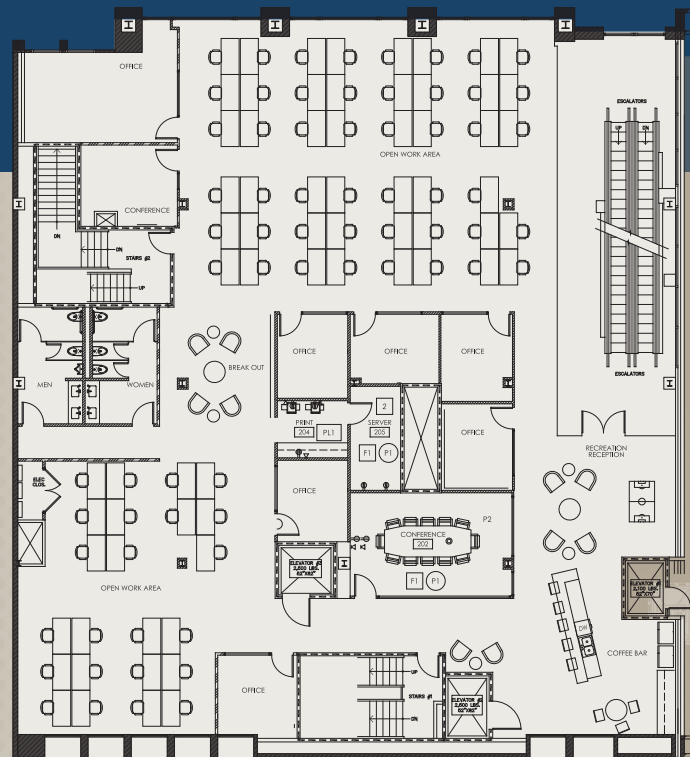

© 2023 CBRE, Inc. All rights reserved. This information has been obtained from reliable sources but has not been verified for accuracy or completeness. CBRE, Inc. makes no guarantee, representation, or warranty and accepts no responsibility or liability for the accuracy, completeness, or reliability of the information contained herein. You should conduct a careful, independent investigation of the property and verify all information. Any reliance on this information is solely at your own risk. CBRE and the CBRE logo are service marks of CBRE, Inc. All other marks displayed on this document are the property of their respective owners, and the use of such marks does not imply any affiliation with or endorsement of CBRE. Photos herein are the property of their respective owners. Use of these images without the express written consent of the owner is prohibited.

