

# Suite 300

3,600 SF

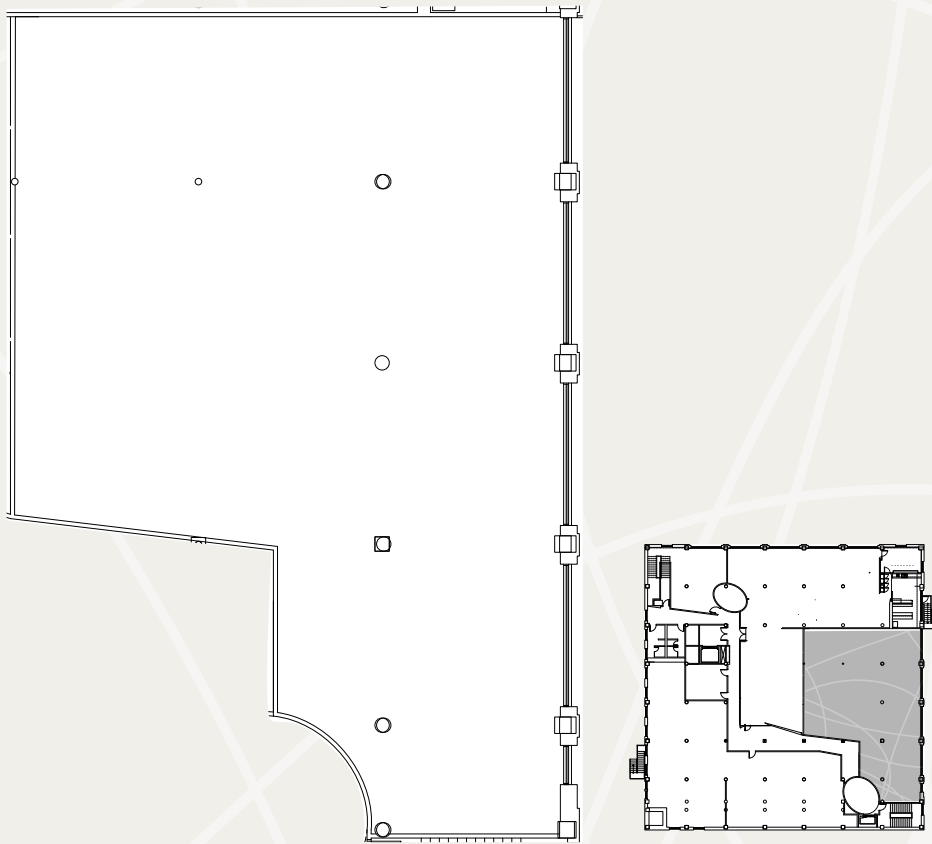

INSPIRATION



610 N FAIRBANKS



17'

HIGH CEILINGS



FLOOR TO CEILING  
WINDOWS



PRIME STREETERVILLE  
LOCATION ACROSS  
FROM NWMH

CONTACT:

Seth Tuscher

+1 630 334 5408

seth.tuscher@cbre.com

**CBRE**

© 2025 CBRE, Inc. All rights reserved. This information has been obtained from sources believed reliable but has not been verified for accuracy or completeness. CBRE, Inc. makes no guarantee, representation or warranty and accepts no responsibility or liability as to the accuracy, completeness, or reliability of the information contained herein. You should conduct a careful, independent investigation of the property and verify all information. Any reliance on this information is solely at your own risk. CBRE and the CBRE logo are service marks of CBRE, Inc. All other marks displayed on this document are the property of their respective owners, and the use of such marks does not imply any affiliation with or endorsement of CBRE. Photos herein are the property of their respective owners. Use of these images without the express written consent of the owner is prohibited. PMStudio\_March2024