

For Lease

CBRE

# Interstate Crossings I

2985 Lone Oak Circle | Eagan, MN



## Contact Us

**BRYAN  
VAN HOOF**

+1 952 924 4624

[bryan.vanhoof@cbre.com](mailto:bryan.vanhoof@cbre.com)

**JEFF  
PRZYTARSKI**

+1 952 924 4895

[jeff.przytarski@cbre.com](mailto:jeff.przytarski@cbre.com)

**SAM  
MANKE**

+1 763 398 9047

[sam.manke@cbre.com](mailto:sam.manke@cbre.com)

# Site Plan

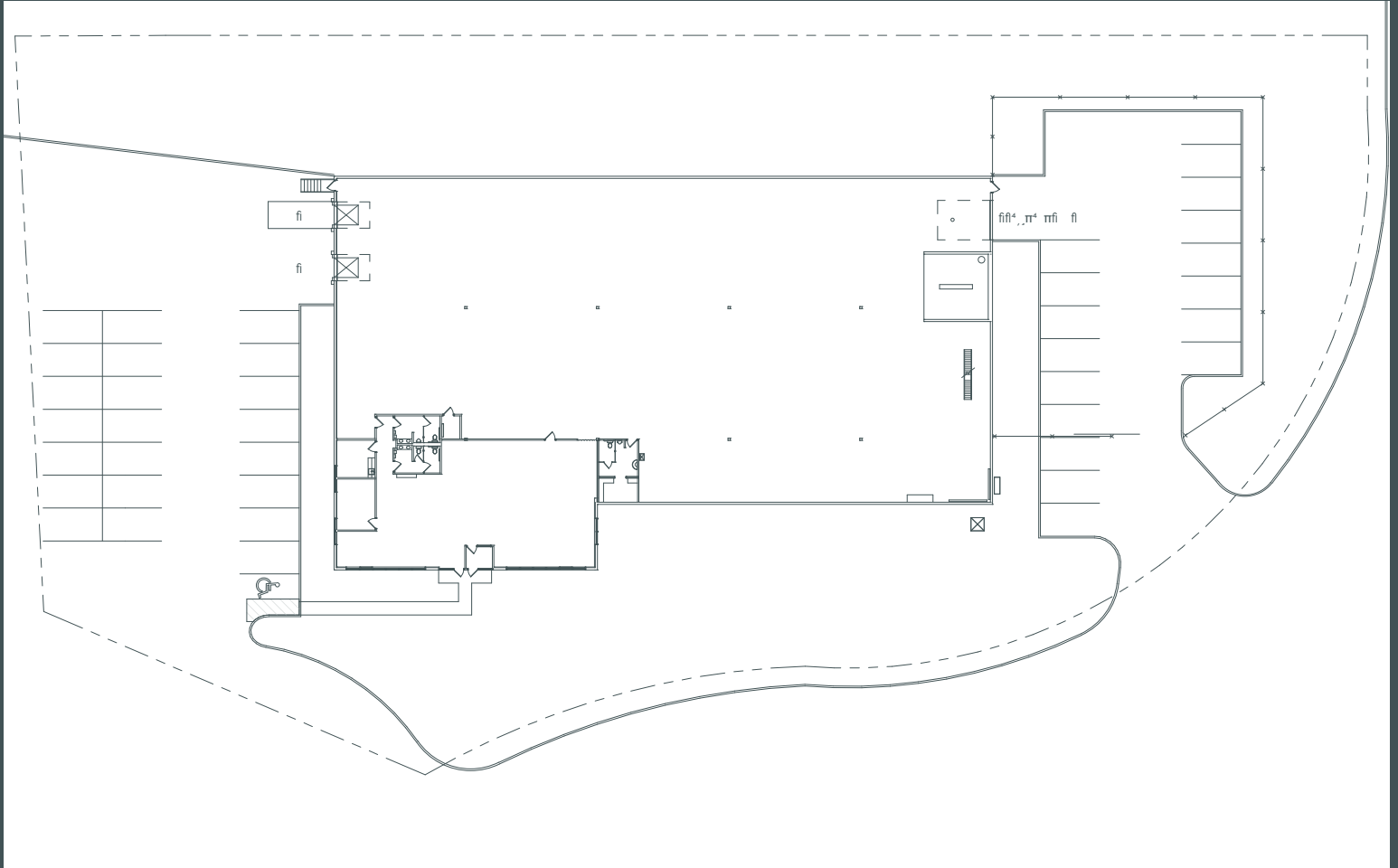

## Property Overview

- + Total Building SF: 21,600 SF
- + Space Available SF:
  - + Office: 3,603 SF
  - + Warehouse: 17,997 SF
- + Loading: 2 Docks | 1 Drive-in
- + Year Built: 1995
- + Clear Height: 24'
- + Power: 480V, 300 Amps, 3 Phase
- + Column Spacing: 40' x 40'
- + Bay Depth: 200'
- + Lease Rates: Negotiable
- + 2025 Tax/CAM: \$3.98
- + Parking: 25 Stalls
- + Fenced outside storage available
- + Bay Depth: 200'

# Photos



# Location Map

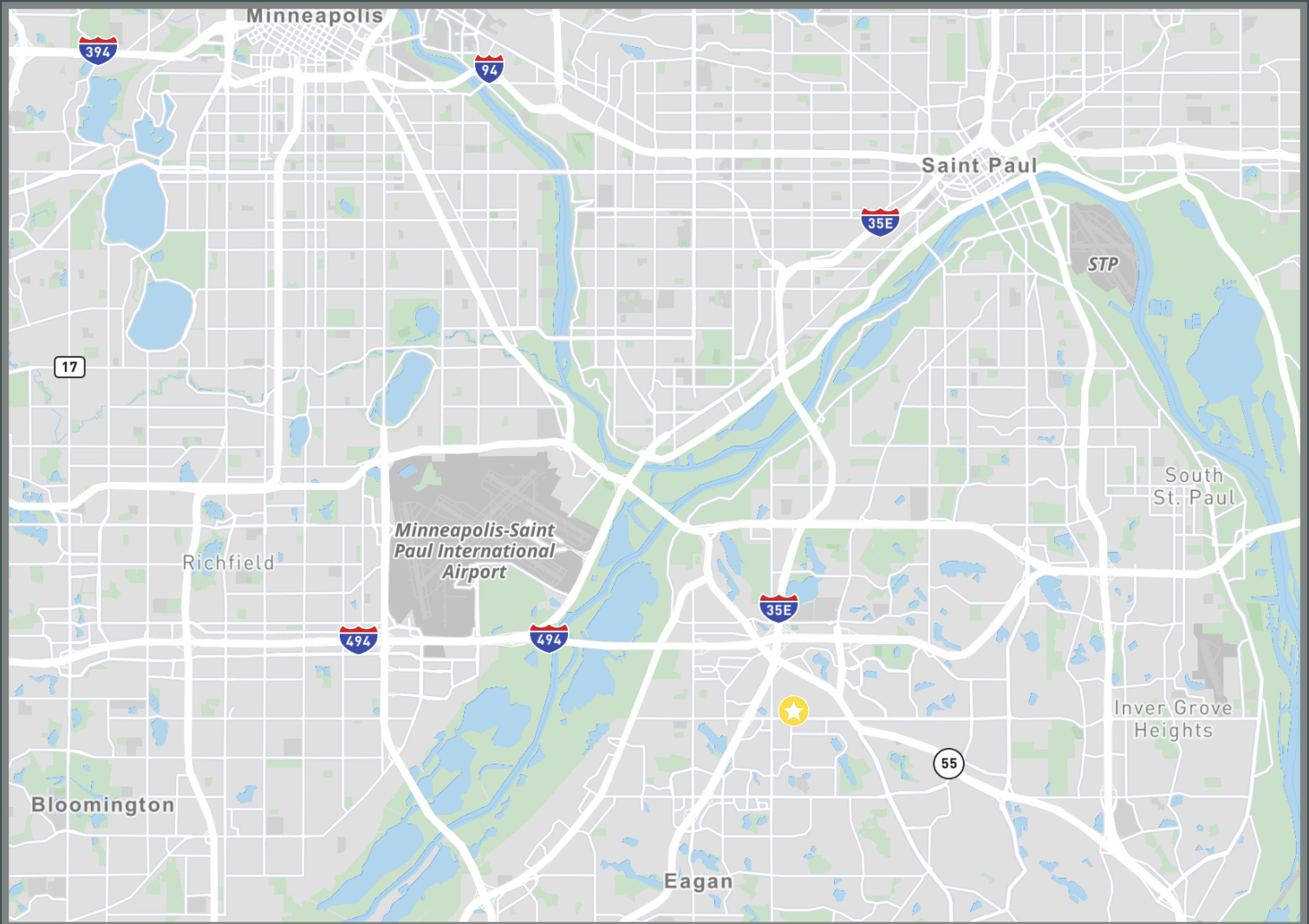

**1 Minute**

I - 35E

**7 Minutes**

I - 494

**9 Minutes**

MSP AIRPORT

**15 Minutes**

ST. PAUL

**22 Minutes**

MINNEAPOLIS

## Contact Us

**BRYAN  
VAN HOOF**

+1 952 924 4624

[bryan.vanhoof@cbre.com](mailto:bryan.vanhoof@cbre.com)

**JEFF  
PRZYTARSKI**

+1 952 924 4895

[jeff.przytarski@cbre.com](mailto:jeff.przytarski@cbre.com)

**SAM  
MANKE**

+1 763 398 9047

[sam.manke@cbre.com](mailto:sam.manke@cbre.com)

© 2025 CBRE, Inc. All rights reserved. This information has been obtained from sources believed reliable, but has not been verified for accuracy or completeness. You should conduct a careful, independent investigation of the property and verify all information. Any reliance on this information is solely at your own risk. CBRE and the CBRE logo are service marks of CBRE, Inc. All other marks displayed on this document are the property of their respective owners, and the use of such logos does not imply any affiliation with or endorsement of CBRE. Photos herein are the property of their respective owners. Use of these images without the express written consent of the owner is prohibited.

**CBRE**