

# For Lease

1660 SW 13TH COURT  
POMPAÑO BEACH, FL 33069



# Pompano Warehouse & Storage Site



## Infill Heavy Industrial Storage Site

### Highlights

- + Tremendous parking & outdoor storage capabilities
- + Complete redevelopment in process
- + Building with outdoor storage/parking available for lease
- + Fully lit, drained, paved and secured site
- + Fenced point of ingress/egress
- + Site is located in a qualified HUBZone

AVAILABLE BUILDING SPACE

**18,036 SF**

AVAILABLE FOR OUTSIDE  
STORAGE AND/OR PARKING

**2.9 ACRES**

EXPECTED COMPLETION

**Q2 2025**

**Larry Genet**  
Executive Vice President  
+1305 807 0004  
larry.genet@cbre.com

**Michael Oretsky**  
Vice President  
+1954 798 4284  
michael.oretzky@cbre.com

**CBRE**

**JIOS**  
A Jadian Company

# Site Availability Specs

1660 SW 13th Court, Pompano Beach

**±18,036 SF / 2.9 Acres**

- + Building size: 18,036 SF
- + Office SF available: ±4,000 SF
- + Clear Height: 18'
- + 8 grade-level, roll up doors: (3) 8' x 10' (3) 10' x 12' (1) 10' x 12' (1) 12' x 20'
- + 200 Amps, 240 Volt, 3-phase heavy power
- + 2.9 acres available space for trailer parking as well as outdoor storage

**±951 SF Stand-Alone Shop or Warehouse**

- + Building size: 951 SF
- + Clear Height: 18''
- + 1 grade-level, roll up door 12' x 20'
- + 200 Amps, 240 Volt, 3-phase heavy power

## Site Plan



# Property Highlights

1660 SW 13TH COURT  
POMPANO BEACH, FL 33069



On behalf of the Owner, CBRE, as exclusive marketing advisor, is pleased to offer for lease an industrial IOS site located in Broward County, Florida. The property is located off the Andrews Avenue and just minutes from I-95 and the Florida Turnpike with immediate access to all major highways.

- + Site has both oversized drive-in doors and dock high loading
- + Major renovations underway

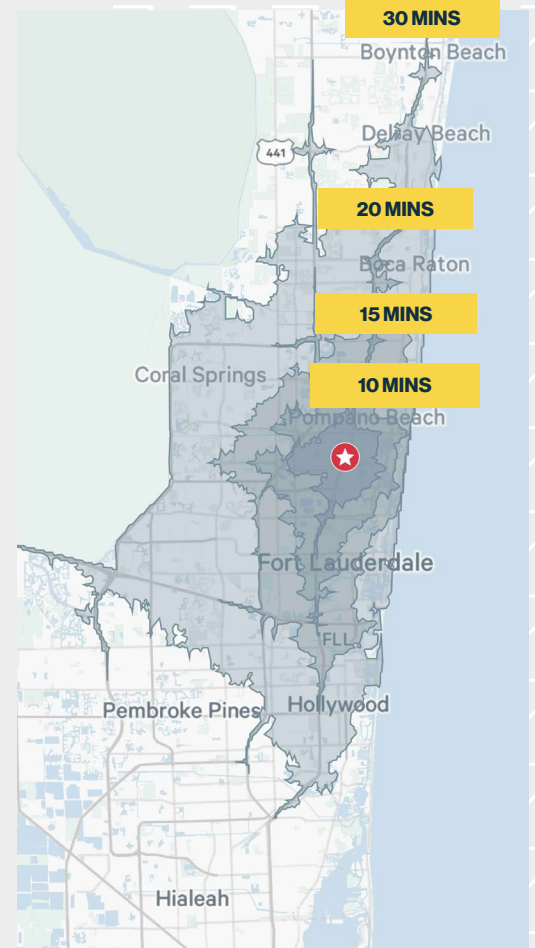

## Details

<b>Property Address</b>	1660 NW 13th Court, Fort Lauderdale, FL
<b>Total Lot Size</b>	2.9 acres
<b>Office SF</b>	±2,000 SF
<b>Clear Height</b>	18'
<b>Zoning</b>	I-1, Industrial City of Pompano Beach

## Access Aerial





# Additional Property Views



# Renderings

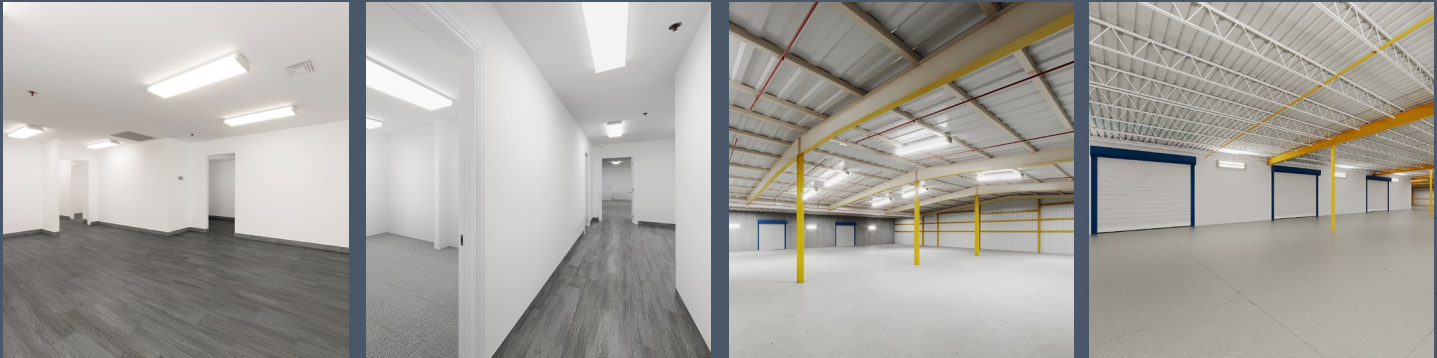

**Larry Genet**  
Executive Vice President  
+1 305 807 0004  
larry.genet@cbre.com

**Michael Oretsky**  
Vice President  
+1 954 798 4284  
michael.oretzky@cbre.com



© 2025 CBRE, Inc. All rights reserved. This information has been obtained from sources believed reliable but has not been verified for accuracy or completeness. CBRE, Inc. makes no guarantee, representation or warranty and accepts no responsibility or liability as to the accuracy, completeness, or reliability of the information contained herein. You should conduct a careful, independent investigation of the property and verify all information. Any reliance on this information is solely at your own risk. CBRE and the CBRE logo are service marks of CBRE, Inc. All other marks displayed on this document are the property of their respective owners, and the use of such marks does not imply any affiliation with or endorsement of CBRE. Photos herein are the property of their respective owners. Use of these images without the express written consent of the owner is prohibited.