

SUBLEASE OPPORTUNITY SUITE 300 - 25,380 RSF

HIGH-END PLUG & PLAY SPACE AVAILABLE



Park West I

1501 - 1503 Lyndon B Johnson Fwy, Dallas, TX 75234



Floor Plan

Suite 300

25,380 RSF

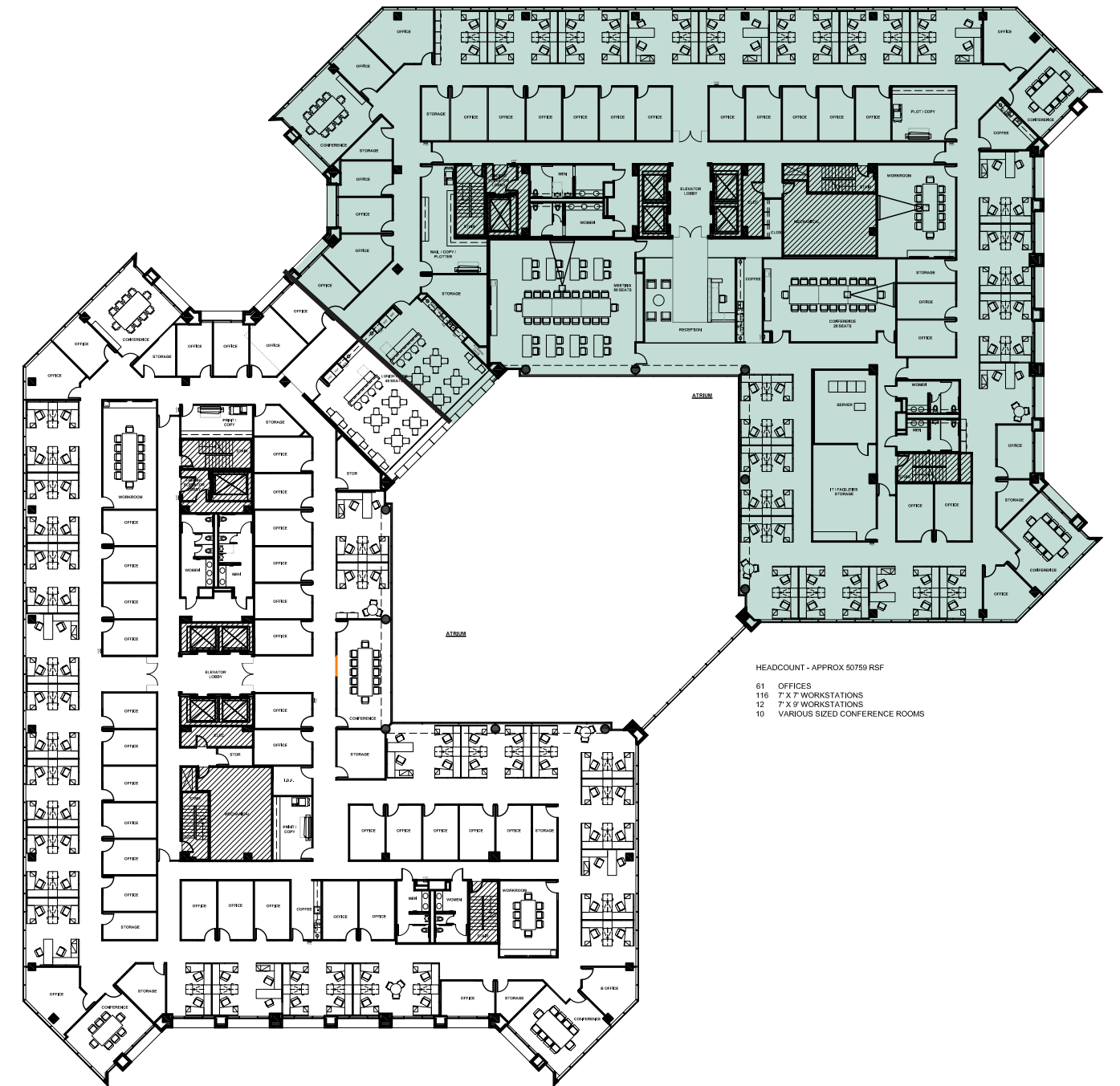

SUBLELEASE FEATURES:

- Size: 25,380 RSF
- Rate: \$19.99 + E
- Term Expires: June 30, 2027
- Parking Ratio; 3.5 per 1,000

THE BUILDING:

- On-site management
- 125 person conference center
- First class fitness facility
- On-site cafe
- On-site security officers
- Wi-Fi in lobby
- Short drive to DFW & Love Field Airports





FOR MORE INFORMATION, CONTACT:

WALKER LAFITTE

First Vice President
214.686.8959
walker.lafitte@cbre.com

ROCK LINTON

Vice President
214.673.5975
rock.linton@cbre.com

© 2025 CBRE, Inc. All rights reserved. This information has been obtained from sources believed reliable, but has not been verified for accuracy or completeness. You should conduct a careful, independent investigation of the property and verify all information. Any reliance on this information is solely at your own risk. CBRE and the CBRE logo are service marks of CBRE, Inc. All other marks displayed on this document are the property of their respective owners, and the use of such logos does not imply any affiliation with or endorsement of CBRE. Photos herein are the property of their respective owners. Use of these images without the express written consent of the owner is prohibited.

