

1400 Eastchester Drive

Suite 200 | High Point, NC 27265

www.cbre.com/triad



Building Overview

- + **Available Space:** 10,919 RSF
- + **Lease Expiration:** 10/31/2028
- + Fully furnished
- + Well-located building
- + Flexible space options and configurations
- + Close proximity to PTI Airport with hotels, restaurants and retail shopping nearby
- + Easy access to Hwy 68, I-74, US-421, I-40, I-840 (Greensboro Urban Loop), and Wendover Avenue

Floor Plan

10,919 SF
AVAILABLE

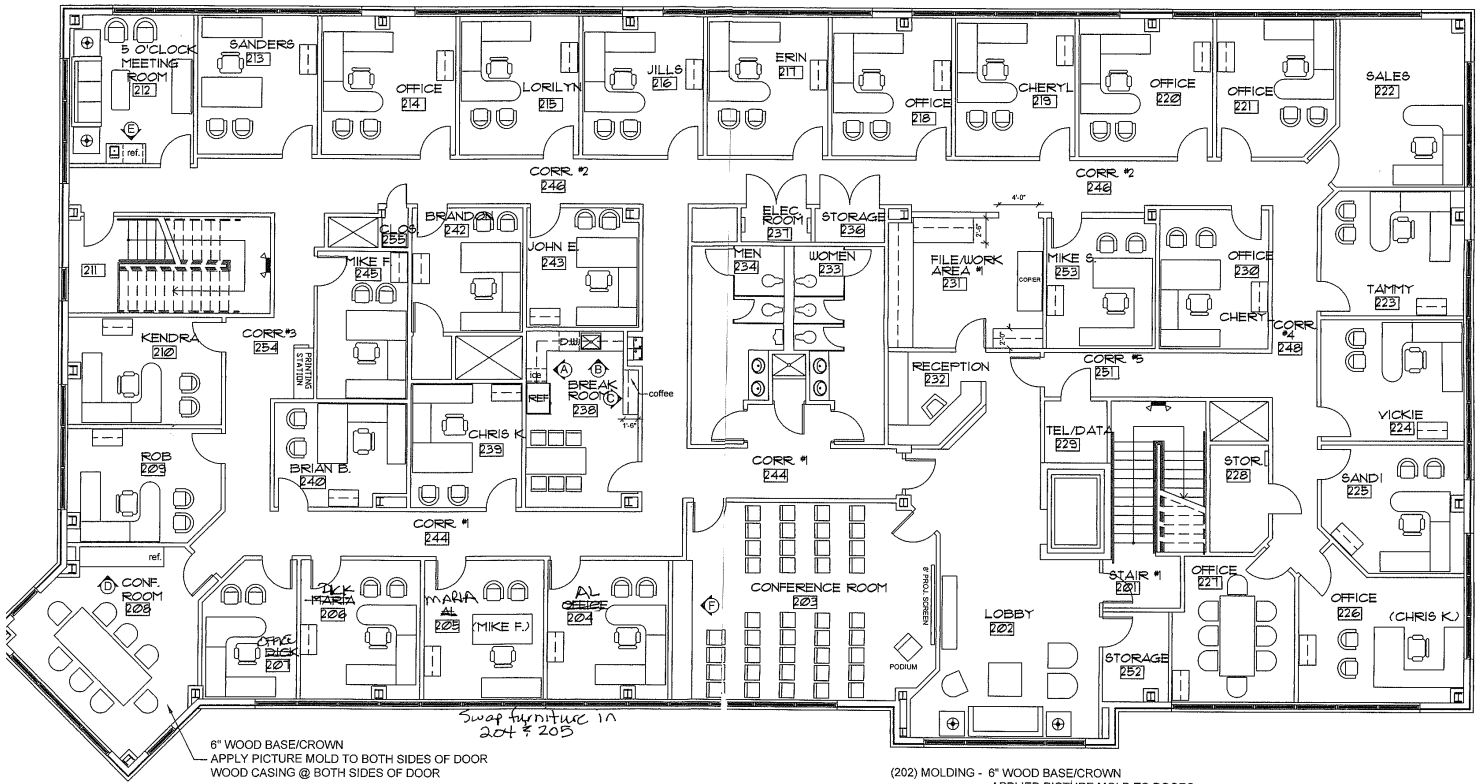

SECOND FLOOR - FURNITURE PLAN

SCALE: 1/8" = 1'-0"

1400 Eastchester Drive

Suite 200 | High Point, NC 27265

For Sublease

2024 Demographics	1 Mile	3 Miles	5 Miles
Population	6,014	63,150	126,741
Employees	2,297	24,628	57,259
Median Age	39.4	38.8	39.5
Households	2,451	24,619	50,989
Average Household Income	\$80,986	\$84,220	\$93,298
Average Value of Owner Occupied Housing Units	\$268,156	\$280,157	\$293,894
Daytime Workers	3,142	26,600	58,976
Daytime Residents	3,164	35,405	67,846

*Source: CBRE Fast Reports

Traffic Counts	
Eastchester Dr	46,000 VPD
I-74	47,500 VPD
N Main St	27,500 VPD
N University Pkwy	12,500 VPD
Johnson St	15,000 VPD
N Centennial St	9,300 VPD

*Source: NCDOT



Contact Us

Jackson Williams

Associate
 +1 336 714 0384
 jackson.williams@cbre.com

Richard Mossman

Executive Vice President
 +1 336 499 9956
 richard.mossman@cbre.com

© 2025 CBRE, Inc. All rights reserved. This information has been obtained from sources believed reliable, but has not been verified for accuracy or completeness. You should conduct a careful, independent investigation of the property and verify all information. Any reliance on this information is solely at your own risk. CBRE and the CBRE logo are service marks of CBRE, Inc. All other marks displayed on this document are the property of their respective owners, and the use of such logos does not imply any affiliation with or endorsement of CBRE. Photos herein are the property of their respective owners. Use of these images without the express written consent of the owner is prohibited.