

100 Biscayne

SUITE 1600
3,595 SF

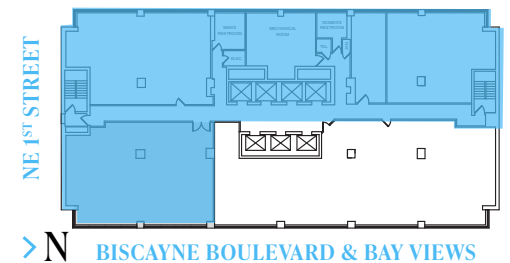
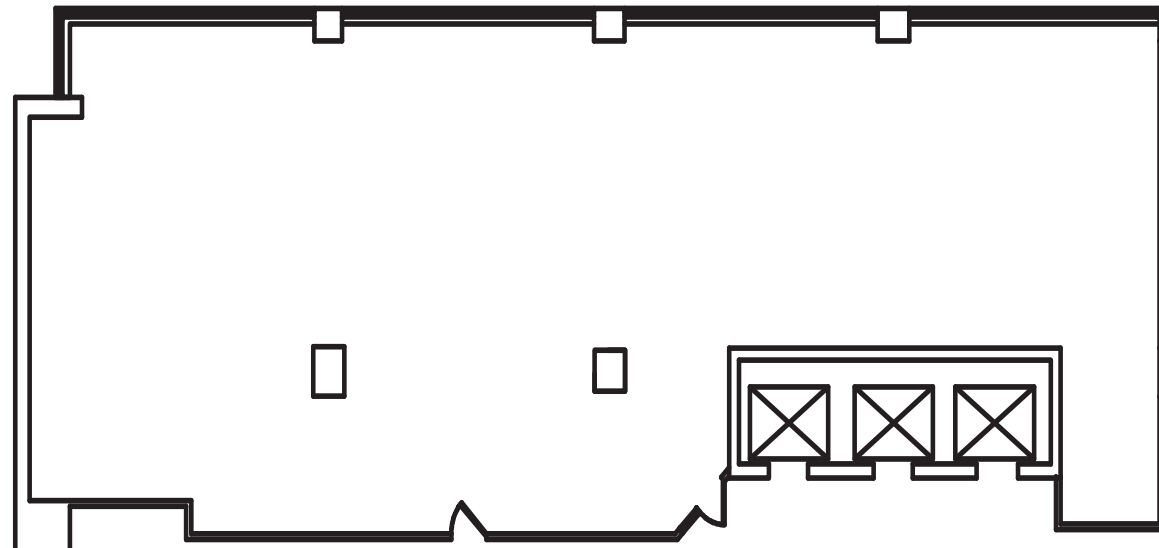
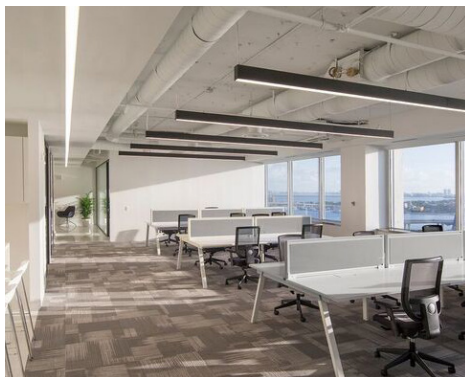

100biscayneblvd.com

RFR **CBRE**

**LEASING
CONTACTS:**

Cameron Tallon
Senior Vice President
407-284-7455
cameron.tallon@cbre.com

Eric Groffman
Executive Vice President
786-390-7497
eric.groffman@cbre.com

Randy Carballo
Senior Vice President
305-299-9163
randy.carballo@cbre.com