

3201

E ELWOOD ST

3201 E Elwood Street | Phoenix, AZ

First Floor

± 35,550 SF

For more information, contact:

Mark Gustin, SIOR, CCIM
602 430 0605
Mark.Gustin@cbre.com

Jimmy Cornish
602 980 8844
Jimmy.Cornish@cbre.com

CBRE

© 2025 CBRE, Inc. All rights reserved. This information has been obtained from sources believed reliable but has not been verified for accuracy or completeness. CBRE, Inc. makes no guarantee, representation or warranty and accepts no responsibility or liability as to the accuracy, completeness, or reliability of the information contained herein. You should conduct a careful, independent investigation of the property and verify all information. Any reliance on this information is solely at your own risk.



Potential Building
Lounge/Grab & Go

Existing Kitchen
Potential Recapture

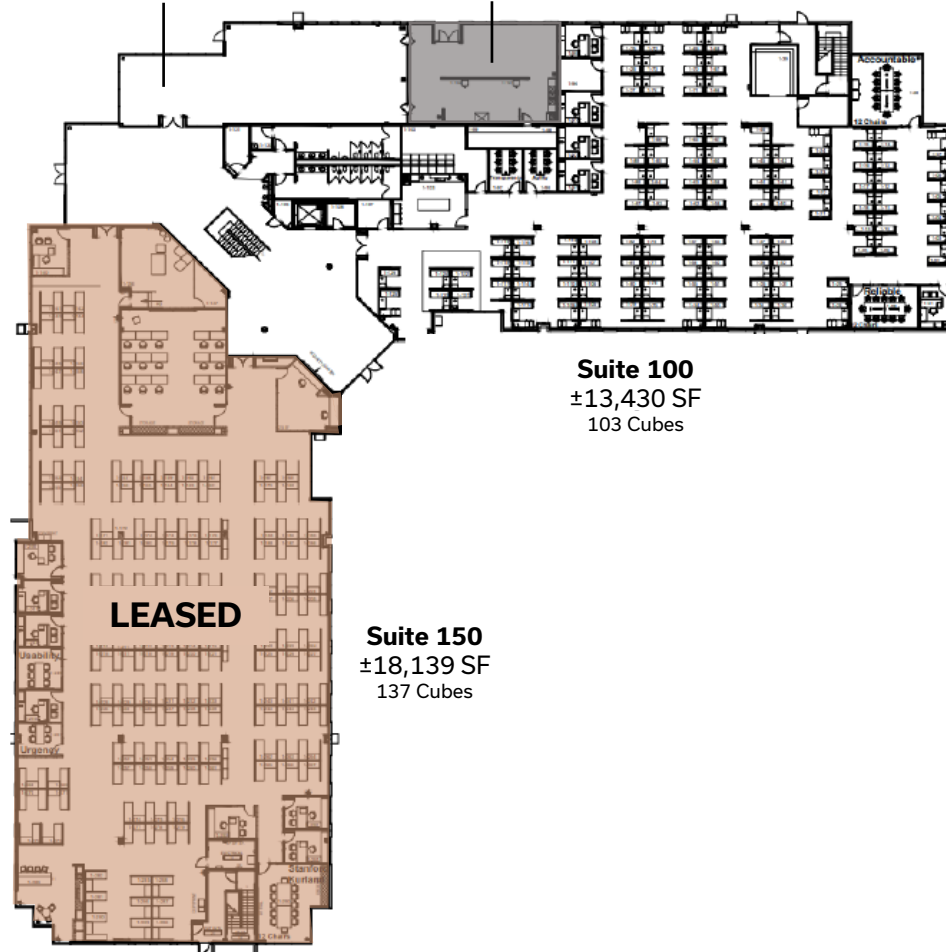

Suite 100
±13,430 SF
103 Cubes

Suite 150
±18,139 SF
137 Cubes