



**CLARION PARTNERS**

**For Lease**

Pompano Business Center

2012 NW 25th Street

Pompano Beach, FL 33069

**46,800 Square Feet Available**



## BUILDING HIGHLIGHTS

- ±46,800 SF available
- ±2,200 SF office
- 14 dock-high doors
- 1 oversized ramp (20' W x 16' H)
- 24' clear height
- Insulated roof
- LED lighting
- ESFR sprinkler system
- 40'x40' column spacing
- Zoning I-1, City of Pompano Beach
- Less than 1 mile from Florida Turnpike and I-95
- Available 10/1/2025

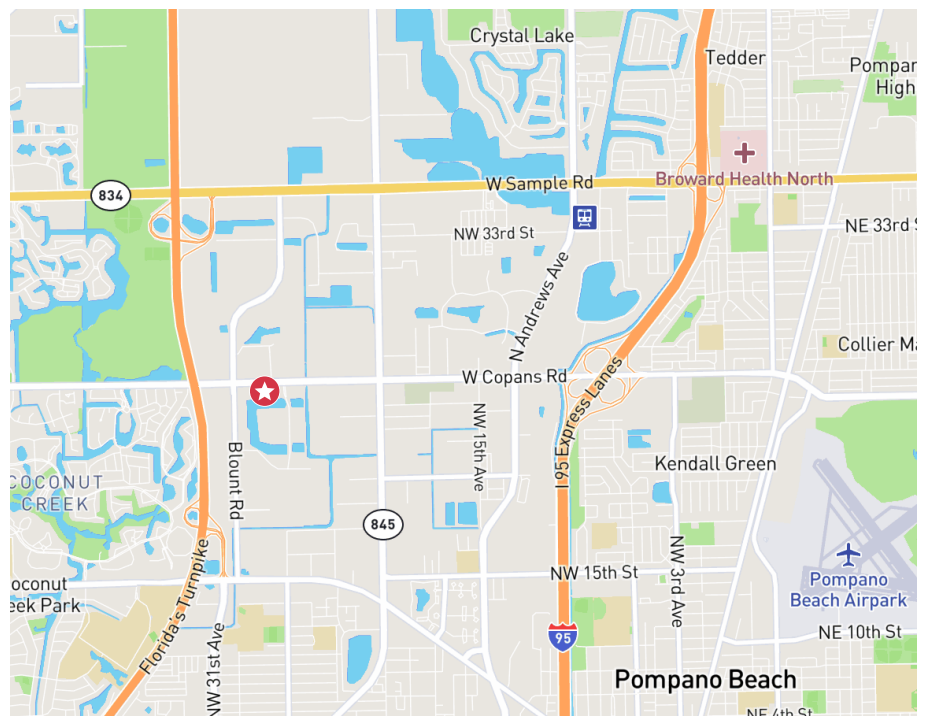



**CLARION PARTNERS**

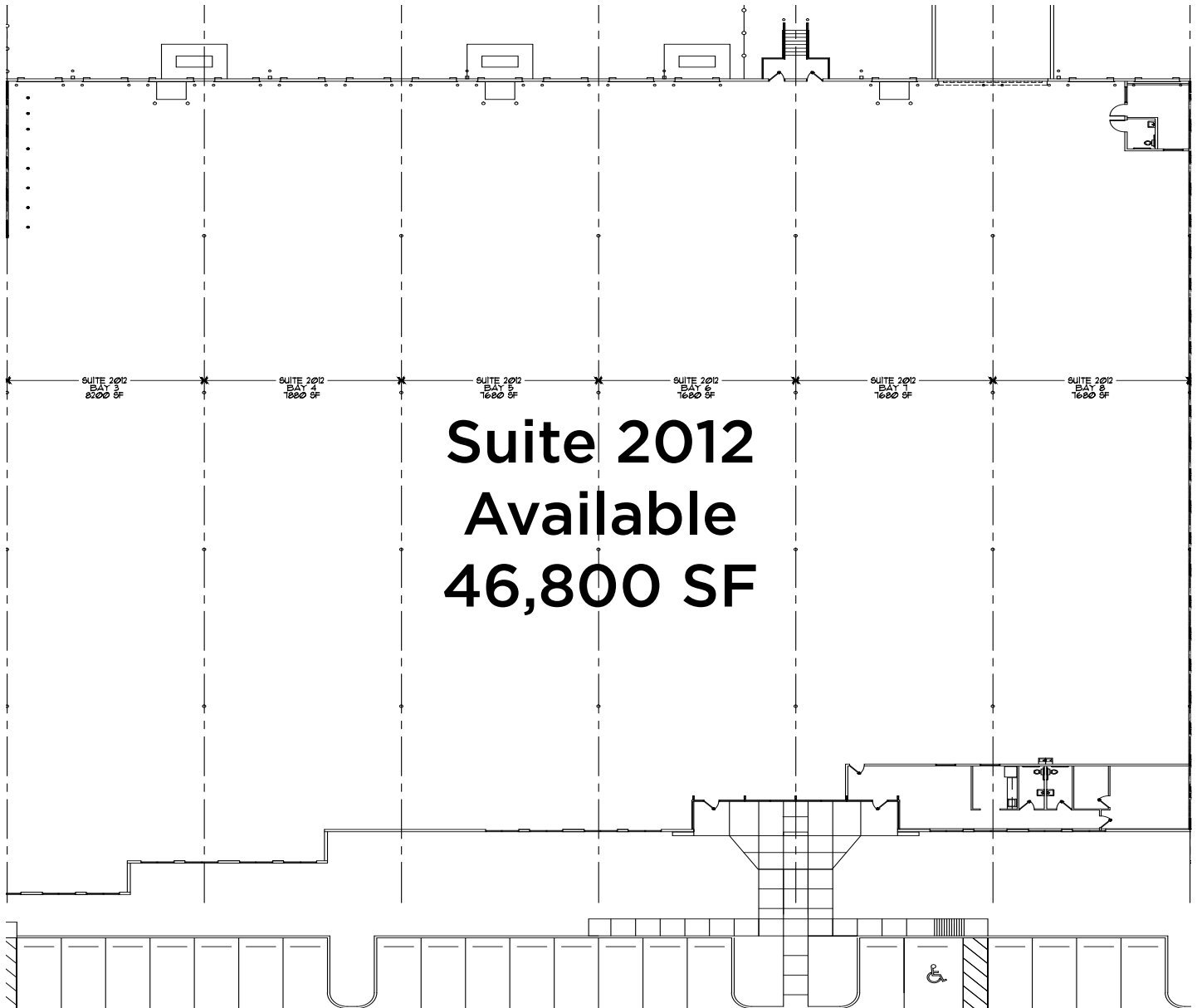

**Suite 2012  
Available  
46,800 SF**

Pompano Business Center is an institutionally owned business park having several size spaces available. The available space features  $\pm 46,800$  SF with  $\pm 2,200$  SF office. With an ESFR fire suppression system, 24' clear heights, dock-high loading and new renovations, Pompano Business Center is well-positioned in the marketplace.



**CLARION PARTNERS**  
[www.clarionpartners.com](http://www.clarionpartners.com)

For more information on this opportunity, please contact

**CBRE**

Tom O'Loughlin  
Vice Chairman  
+1 954 817 3919  
[tom.oloughlin@cbre.com](mailto:tom.oloughlin@cbre.com)

Michael Oretsky  
Vice President  
+1 954 798 4284  
[michael.oretzky@cbre.com](mailto:michael.oretzky@cbre.com)