

Brightleaf

Retail Redevelopment in the Heart of Downtown Durham

905 W Main Street
Durham, NC 27701

- + Endcap restaurant space available with 3,571 SF
- + Retail spaces available from 831 SF - 8,130 SF
- + Located within one mile of DPAC and Durham Bulls Athletic Park, and less than two miles to Duke University with a student population of 17,500
- + Retail co-tenants include Flowcorps, Fonda Lupita, Nikos, Clouds Brewing, and Hamilton Hill

2024 DEMOGRAPHICS	1 MILE	3 MILES	5 MILES
Population	19,956	100,961	200,690
Households	8,908	40,365	81,403
Average HH Income	\$125,716	\$92,479	\$100,461
Daytime Population	34,708	144,174	228,854

Contact Us

Cori Nix
Senior Vice President
+1 919 422 3125
cori.nix@cbre.com

Jon Stanley
Senior Vice President
+1 919 622 1684
jon.stanley@cbre.com



Brightleaf Square

905 W Main Street - Ground

For Lease

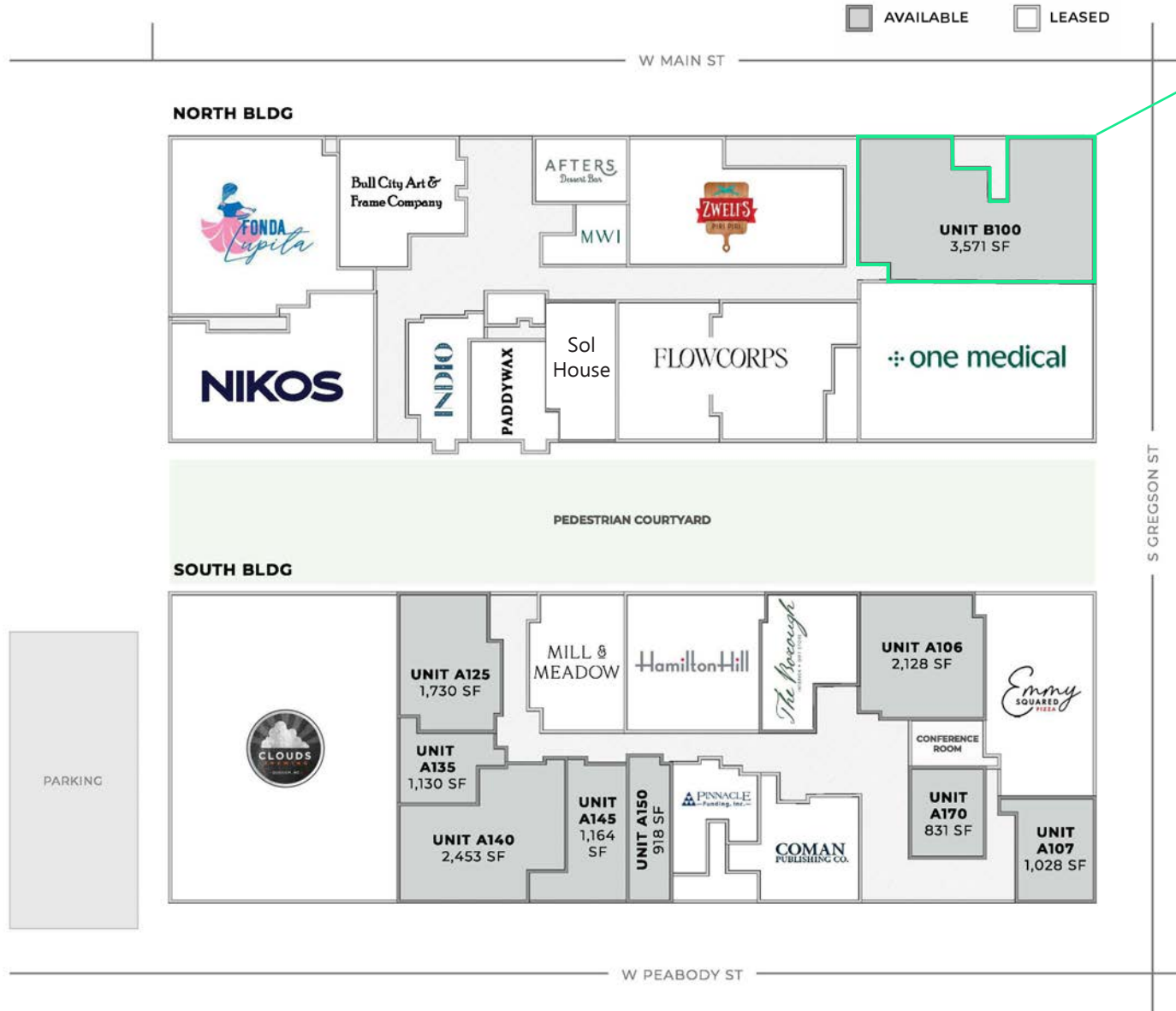

Marquee restaurant space available at highly visible corner of Main St & Gregson St



Peabody Place

112 S Duke Street

For Lease

■ AVAILABLE □ LEASED ▨ PATIO

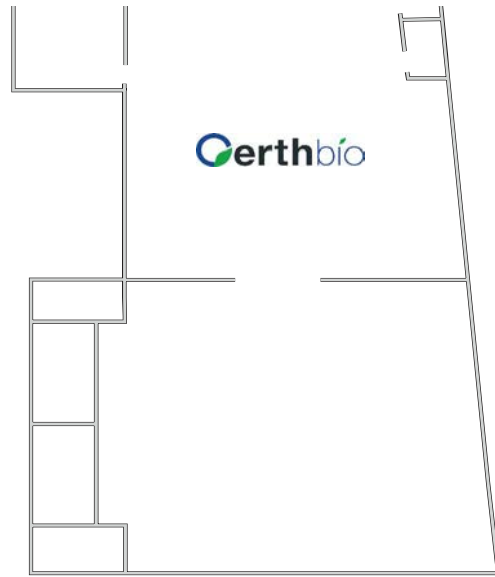

LOWER



GROUND

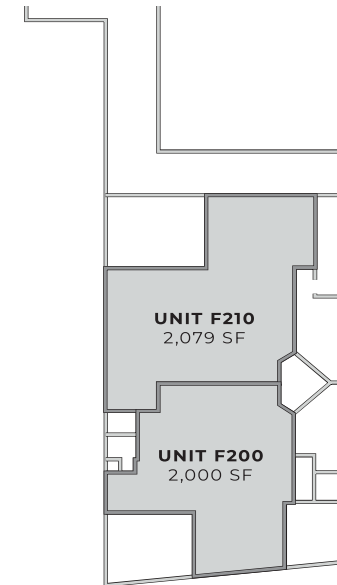

LEVEL 2

S DUKE ST







© 2025 CBRE, Inc. All rights reserved. This information has been obtained from sources believed reliable but has not been verified for accuracy or completeness. CBRE, Inc. makes no guarantee, representation or warranty and accepts no responsibility or liability as to the accuracy, completeness, or reliability of the information contained herein. You should conduct a careful, independent investigation of the property and verify all information. Any reliance on this information is solely at your own risk. CBRE and the CBRE logo are service marks of CBRE, Inc. Photos herein are the property of their respective owners. Use of these images without the express written consent of the owner is prohibited.