

North Cypress Medical Plaza I

21216 Northwest Freeway
Cypress, TX 77429
www.cbre.com/properties

3rd Floor Availabilities

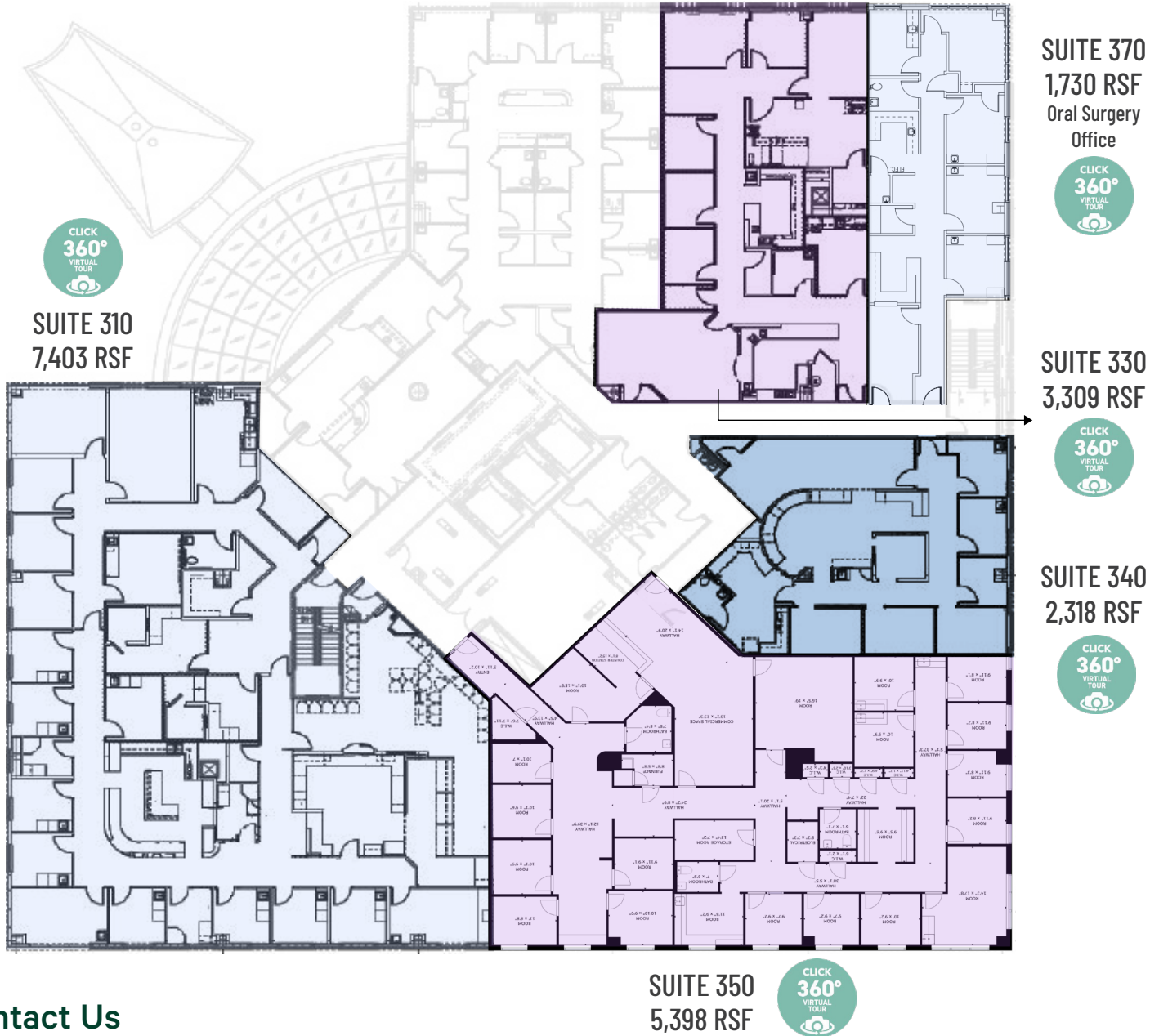

Contact Us

Angela Barber
Vice President
+1 832 455 6945
angela.barber@cbre.com

Danielle Parsons
Associate
+1 713 907 8905
danielle.parsons@cbre.com

*Suite 330/370 - Contiguous for up to 4,769 RSF
*Suite 310/340/350 - Contiguous for up to 15,119 RSF