

FOR SUBLEASE

2365

IRON POINT ROAD

Folsom, California



±6,912 - ±14,275 RSF AVAILABLE

CBRE

PROPERTY HIGHLIGHTS

Updated common area improvements

30+ seat conference and training room

Short walk to numerous amenities

Leed Gold

4.5/1,000 parking area

Fiber ready

Onsite fitness center with showers

High Identity Building

Designated walking paths surround wetlands preserve area

Updated lobby with television and furniture

Concierge Services

±6,912 - ±14,275 RSF

AVAILABLE



FLOOR PLAN

2ND FLOOR
±6,912 - ±14,275 RSF

OPTION A: ±6,912 RSF

OPTION B: ±14,275 RSF

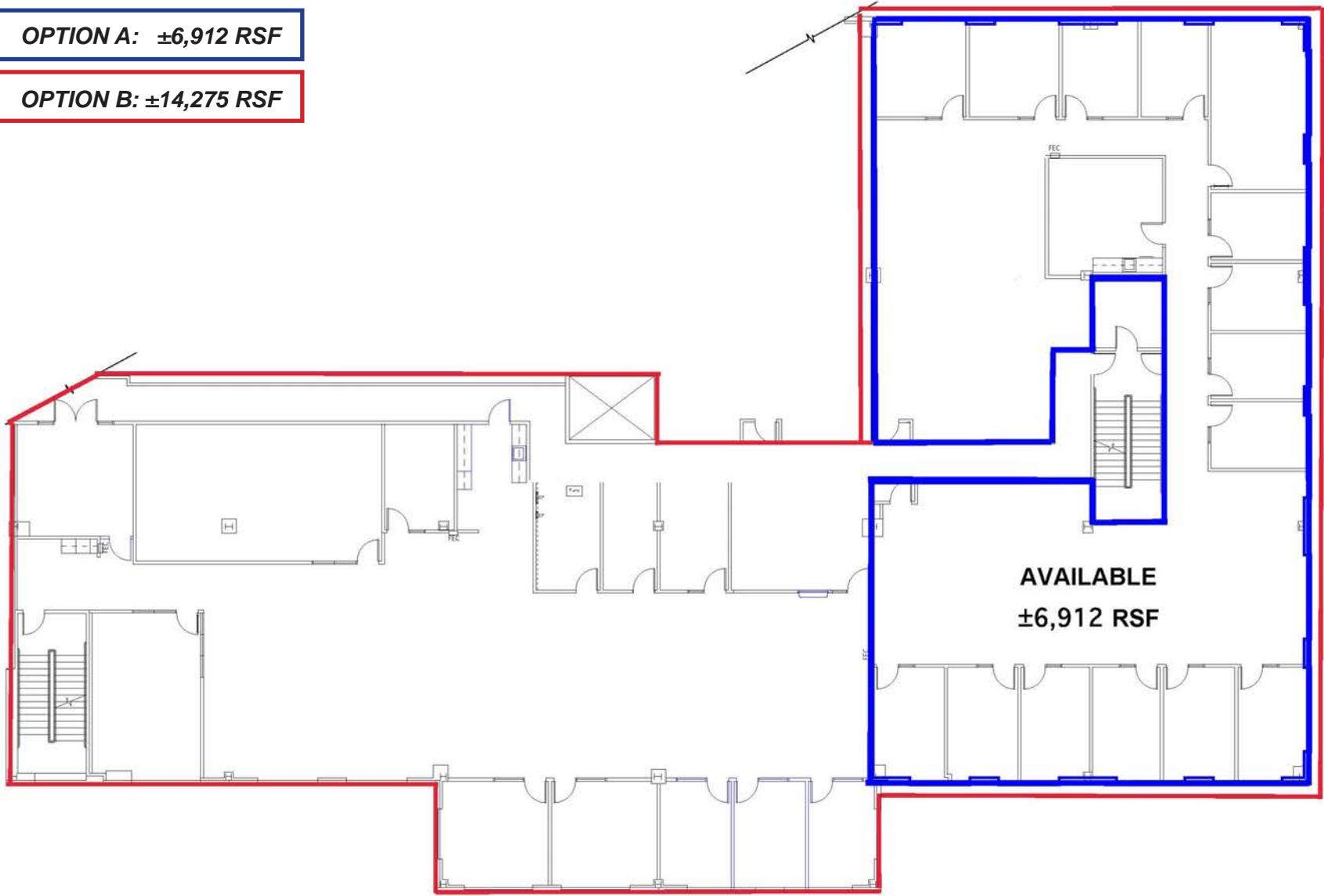

INTERIOR PHOTOS



NEARBY FOLSOM AMENITIES

1

Folsom Gateway
Courtyard by Marriott
Staples
Pieology Pizzeria
REI
Bed Bath & Beyond
Ulta Beauty
Chipotle

2

Palladio Shopping Center
Mas Taco Bar
Panera Bread
Barnes & Noble
Victoria's Secret
Buckhorn BBQ & Grill
Nordstrom Rack
Iron Horse Tavern

3

Broadstone Plaza
Michaels
Round Table Pizza
Famous Footwear
Old Navy
Jamba Juice
Chick-fil-A
Buffalo Wild Wings

4

Broadstone Marketplace
CVS Pharmacy
Party City
European Wax Center
Noodles and Company
Thai Paradise
Temple Coffee Roasters
BJ's Restaurant & Brewhouse



2365

IRON POINT ROAD

Folsom, California

FOR MORE INFORMATION, PLEASE CONTACT:

TONY WHITTAKER

Senior Vice President

+1 916 492 6914

tony.whittaker@cbre.com

Lic. 01780828

NELLIE CRUZ

Vice President

+1 916 492 6915

nellie.cruz@cbre.com

Lic. 02086140

CBRE

WWW.CBRE.US/SACRAMENTO

© 2025 CBRE, Inc. All rights reserved. This information has been obtained from sources believed reliable, but has not been verified for accuracy or completeness. You should conduct a careful, independent investigation of the property and verify all information. Any reliance on this information is solely at your own risk. CBRE and the CBRE logo are service marks of CBRE, Inc. All other marks displayed on this document are the property of their respective owners, and the use of such logos does not imply any affiliation with or endorsement of CBRE. Photos herein are the property of their respective owners. Use of these images without the express written consent of the owner is prohibited. PMStudio_September2025