

THE MERIDIAN AT BRENTWOOD

8374 EAGER ROAD
\$25.00 PER RSF, FULL SERVICE



Open, efficient floor plan



Dedicated MetroLink Stop on site



Tenant break areas



Covered walkway to parking garage



Free 5/1000 Parking in multi-story parking garage



+/- 70,000 SF Available for Lease on 2nd floor



Located in a premier mixed-use development located in one of St. Louis' most desired markets.



Intertwined with premier dining, retail and residential opportunities

FLOOR PLAN

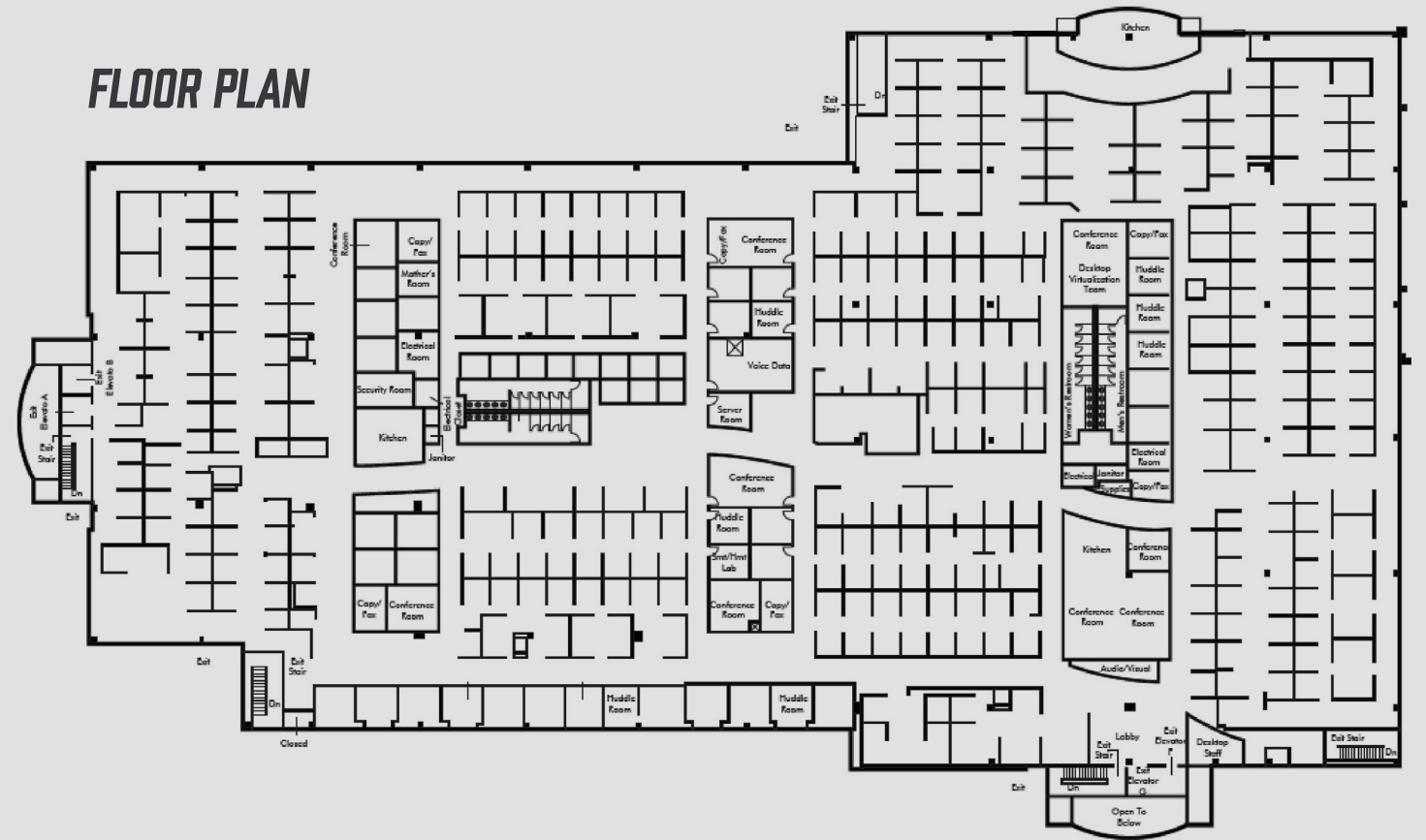

2ND FLOOR	OCCUPIED	AVAILABLE 70,000 SF
1ST FLOOR	OCCUPIED	OCCUPIED



ARTIE KERCKHOFF
CCIM

Senior Vice President
+1 314 655 6016
art.kerckhoff@cbre.com

WHITAKER VARLEY

Senior Vice President
+1 314 655 5930
whitaker.varley@cbre.com

